

**Aanbeveling**

De afstand tussen de houten planken handmatig aanpassen.

Bij gebruik:

Ovengedroogd hout - 18% vochtigheid = min. 5 - 6 mm  
Luchtgedroogd hout - 18% vochtigheid = max. 4 - 5 mm

**Opgelet:** Niet geschikt voor composiet terrasplanken

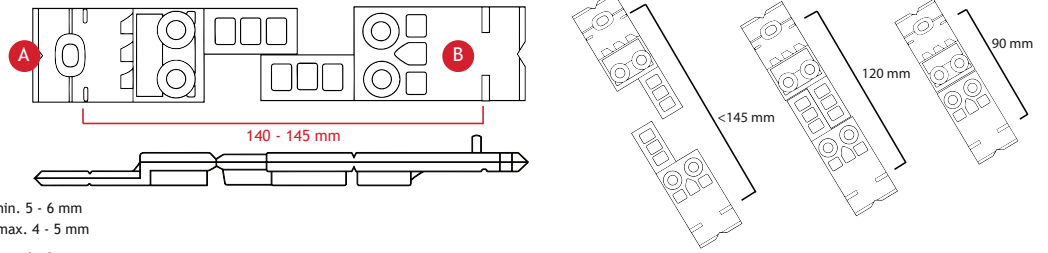

**EERSTE PLANK**

Voorboren wordt sterk aangeraden.  
Boordiameter: 4 mm

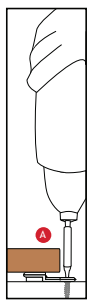
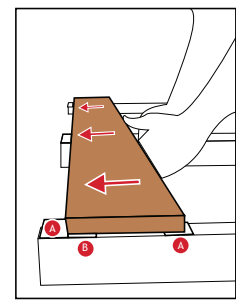
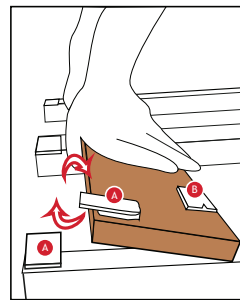
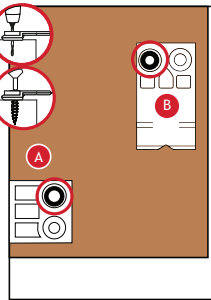
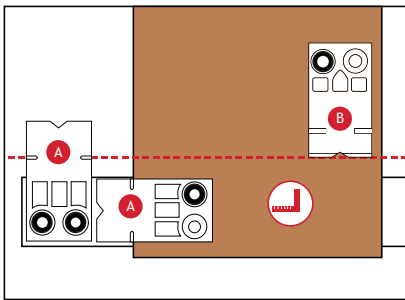
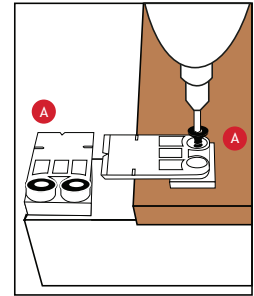
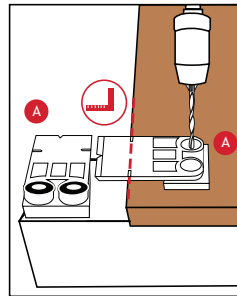
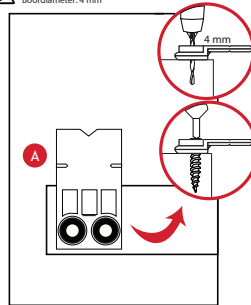
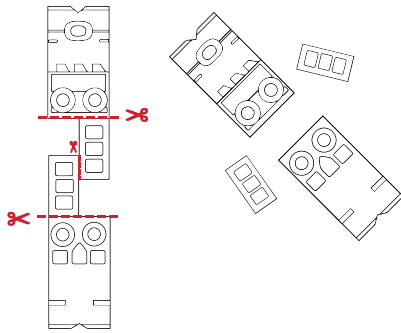

**TUSSENPLANK**

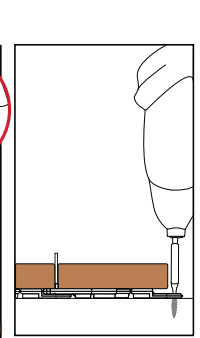
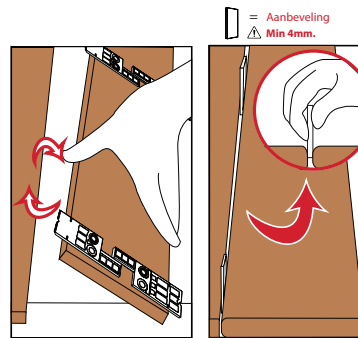
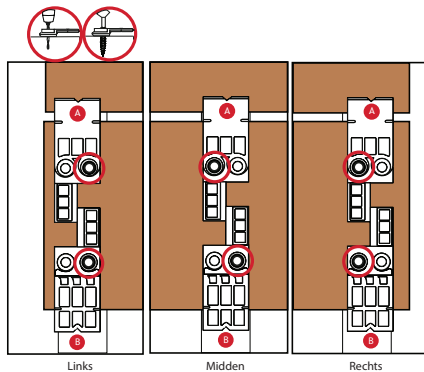
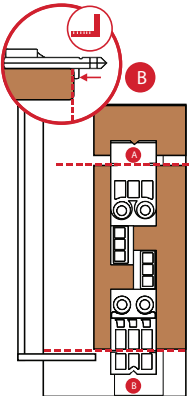

**LAATSTE PLANK**

